

SHERPA GARDEN TROLLEY

With Removable Folding Sides



Owners Manual Model SLGT2

- Important Safety Instructions
- Assembly Instructions
- Parts and Hardware Identification

CAUTION: Read, understand and follow **ALL** instructions before using this product.

WARNING: Not for recreational use. Persons should never ride in the Utility Cart.

Questions, problems, missing parts? Before returning to your retailer, telephone our customer service department on **01522 283020**.

IMPORTANT SAFETY INSTRUCTIONS

1. **READ ALL INSTRUCTIONS CAREFULLY BEFORE USE.** If you do not understand these instructions, or need clarification or further explanation, please call for assistance: 01522 283 020.
2. Do not load cart with more than 350 kg.
3. Do not allow children to use the cart unsupervised. This cart is not a toy.
4. This product is not to be used transporting passengers.
5. This product is not to be used for highway use.
6. Always distribute payload evenly over surface of the bed.
7. Do not load any items on top of the panels. Lower panel when objects are to be loaded onto the cart.
8. If any parts become damaged, broken or misplaced, do not use the cart until replacement parts can be obtained.
9. Do not operate or use on objects that can cause damage to the tires.

SAVE THESE INSTRUCTIONS FOR FUTURE REFERENCE

ASSEMBLY INSTRUCTIONS

Your cart requires assembly. Account for all parts and hardware before beginning assembly. If any parts are missing, damaged or if you have questions or need additional instructions **DO NOT RETURN THIS PRODUCT TO THE RETAILER**, call the Sherpa helpline on 01522 283 020.

Tools required for assembly: Medium size slot screwdriver, 6, 8, and 12mm open end spanner and /or two medium adjustable spanners.

Refer to the exploded drawing and the parts list on the following pages during assembly.

STEP 1 Turn the cart bed upside down. Use the cardboard from the carton to keep from scratching or damaging the finish.

STEP 2 Assemble the rear axle (6) to the back of the bed using (16) 8x20mm support bolts, (17) 8mm washers and (18) 8mm lock nuts. Hand tighten. Next attach the left and right rear axle braces (7&8) using (16) 8x20mm support bolts, (18) 8mm lock nuts, and (17) 8mm washers. Then **tighten all nuts securely.**

STEP 3 Attach the Front Axle Assembly (9) to the bed using (16) 8x20mm bolts, (18) 8mm nuts and (17) 8mm washers with the two axle guides facing inwards / towards the back of the cart (**as shown in Figure 2**)

A. Place the steering link connector on top of the two axle guides and attach using (19) shouldered bolts, (21) nuts and (20) washers **NB only tighten the nuts to remove access play in the thread and ensure free movement from side to side**

B. Secure the center front axle Support (10) to the bed of the cart using (16) 8x20mm bolts, (18) 8mm lock nuts, and (17) 8mm washers.

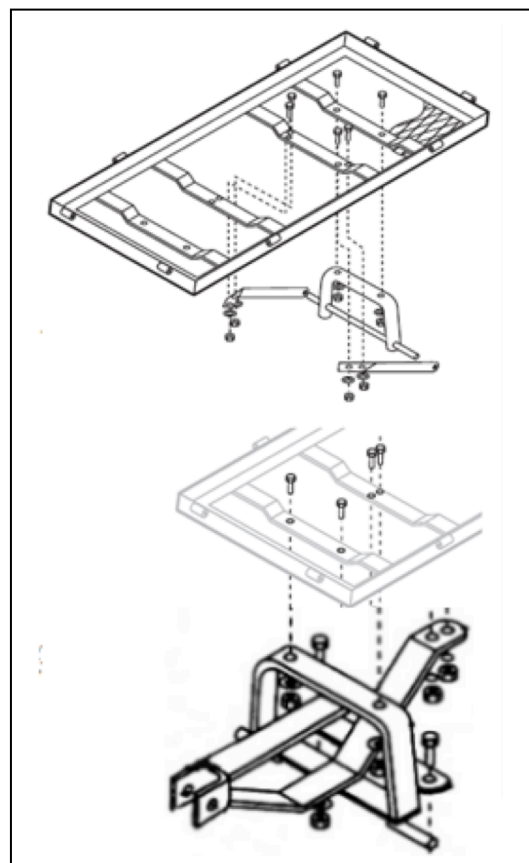

C. Attach the Steering Yoke (11) to the centre of the Front Axle Assembly using the washer and split-pin (22) and washer already attached to the mounting post. Next secure the axle Support and steering link connector using (19) bolts, (21) nuts, and (20) washers (as shown in Figure 3).

NB only tighten the nuts to remove access slack in the thread and ensure free movement from side to side. Shouldered bolts should be used on moving steering parts.

Figure 2.



Figure 3.



STEP 4 Install the wheels in the following order:

1. Smear a little oil or grease onto the axles.
2. Place the wheels onto the axles with the valve Stem facing outward.
3. Use the 12mm washers (24) and Wheel Nuts (23)

STEP 5 Turn the cart upright onto its wheels.

STEP 6 Attach the front, back, left and right panels using the large R Clips (26).

NOTE: Latch the side panels in the upright position using the lock handles. Raise the handles to vertical position, when the bracket is around the lock handle, turn 180° to secure. Tighten the nuts on the lock handles to allow for smooth operation while not being overly tight.

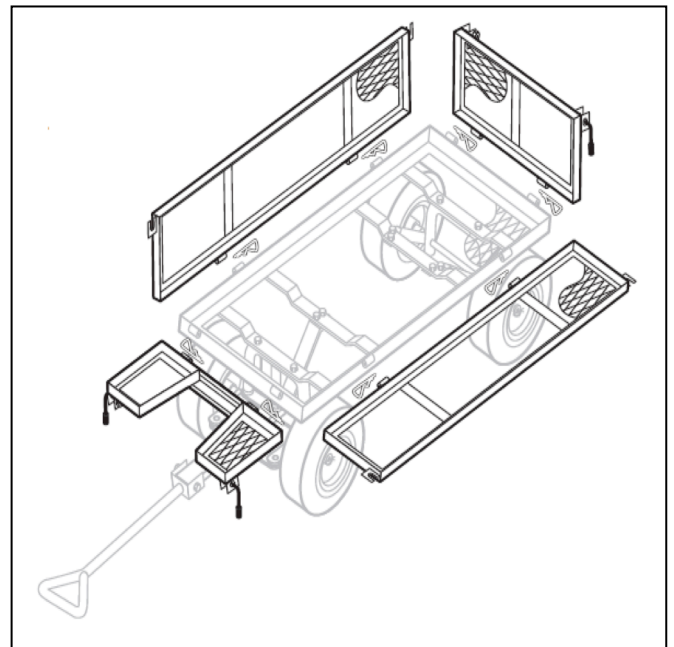

STEP 7 To attach the handle slide the plastic coupling (13) over the end of the tow bar and attach it to the steering yoke using the 8x60mm Bolt and Nut and Washer (25).

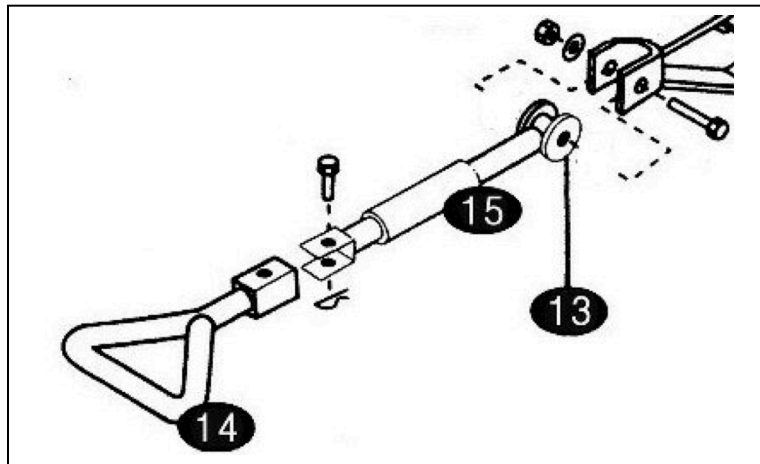

www.sherpatools.co.uk | 01522 283 020

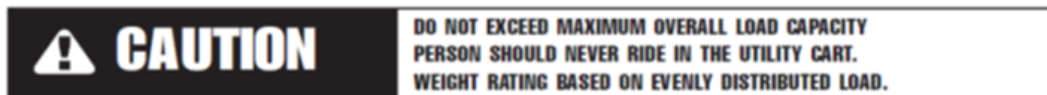

PARTS & HARDWARE IDENTIFICATION

Main Frame Parts		QTY
1	Bed	1
2	Sides	2
3	Front	1
4	Back	1
5	Wheels Assembly	4
Rear Support Assembly		
6	Rear Axle	1
7	Left Rear Axle Brace	1
8	Right Rear Axle Brace	1
Front Support Assembly		
9	Front Axle Support	1
10	Centre Front Axle Brace	1
11	Yoke	1
12	Steering Link Connector	1
13	Plastic Coupling	1
14	Handle	1
15	Tractor / ATV Hitch	1
Assembly Hardware		
16	Support Bolts 8 x 20mm	10
17	Washer 8mm	10
18	Nuts w/lock Inserts 8mm	10
19	Shoulder Bolt	4
20	Shoulder Bolt Washer	4
21	Shoulder Bolt Nut	4
22	Split Pin	1
23	Wheel Nuts 12mm	4
24	Washer (Wheel) 12mm	4
25	Pull Handle Bolt Assembly	1
26	R Clip Large	8



